



## 78 WATERTAXI CLASS

■ ■ ■ SERIES 1020-1021

### GENERAL SPECIFICATIONS

LENGTH OVERALL:	78'6"
HULL BREADTH:	18'0"
HULL DEPTH:	6'8"
MOLDED DRAFT:	2'11"
AIR DRAFT:	14'7"
ENGINES:	280 HP @ 2,500 RPM JOHN DEERE
GENERATOR (1):	21.5 kW CUMMINS
GENERATOR (2):	21.5 kW CUMMINS
CAPACITY:	99 PASSENGERS

### Signature Amenities

- A Classic Design Line
- Climate Controlled Cabin for Extended Service
- All Aluminum Construction
- Low Profile Design for Easy Bridge Access
- Raised Pilot House Design
- Handicap Accessible Head
- Covered Exterior Seating
- Inside Seating for 90 Passengers
- Full Service Snack Bar
- Engineered 24 Step Paint Coating System - Devco
- Non-Skid Deck Surface - Fore, Aft and Bridge

### SkipperLiner Exclusives

- Nationwide SkipperLiner Service Support
- Online Business Management Resource Center
- Yearly Operator's Conference & Show
- Vessel Remarketing Services
- Complete Indoor Manufacturing Process



# 78 WATERTAXI CLASS

SERIES 1020-1021

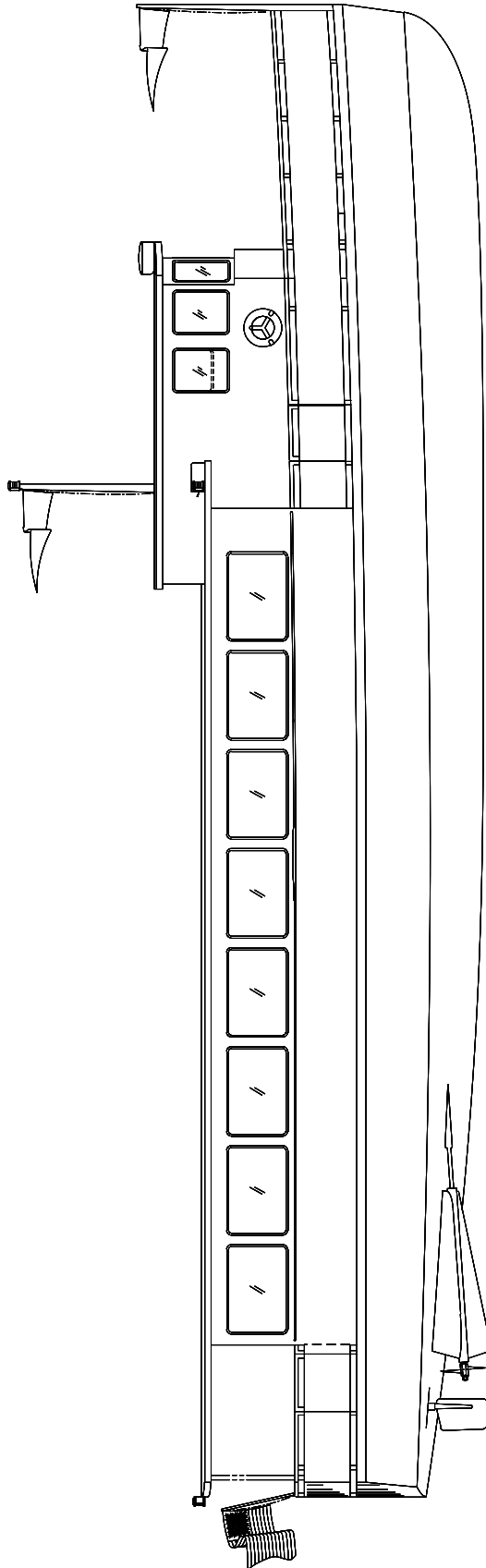

PROFILE

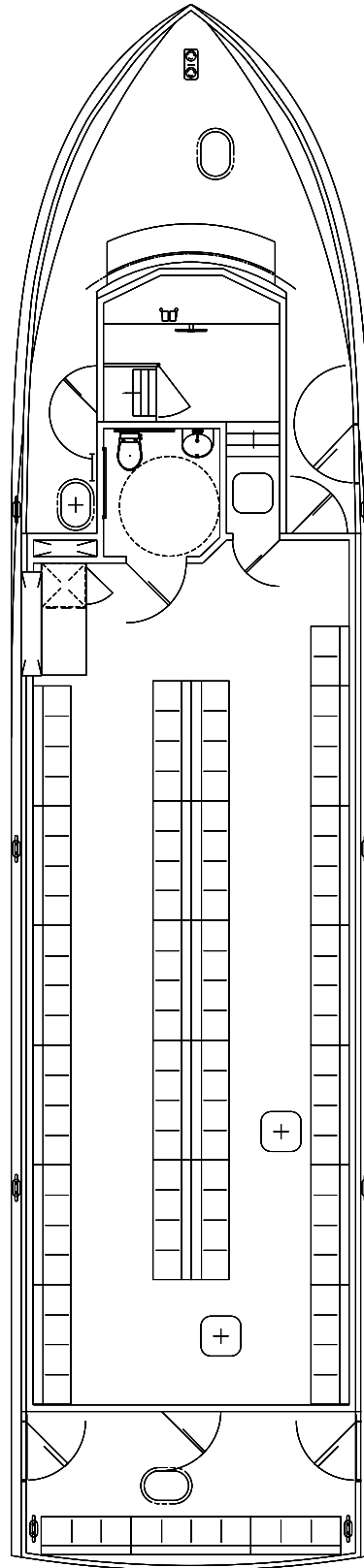

MAIN DECK

